

WiFi Antenna Cable Install Guide

- Package List:**
- WiFi mounting iron box x1
 - WiFi Antenna Cables x2
 - metal gasket x2
 - Hex nut x2
 - Screws x3

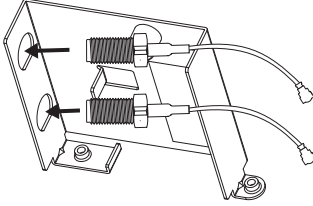

1 The WiFi antenna connector is inserted into the wifi hole.

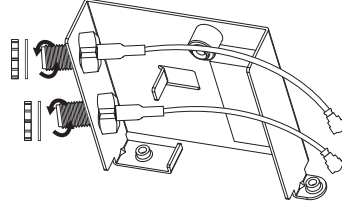

2 Lock the metal gasket and Hex nut.

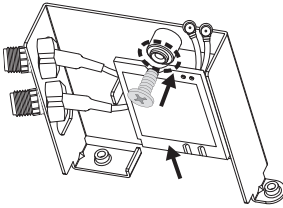

3 Place the wifi cables on the sponge pad, insert the wifi card and tighten the screws.

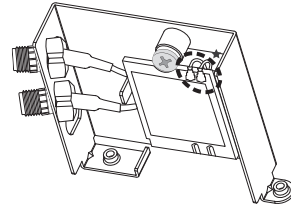

4 WiFi cables connection WiFi card.
★ A screwdriver can be used to assist snap in fastening the connector.

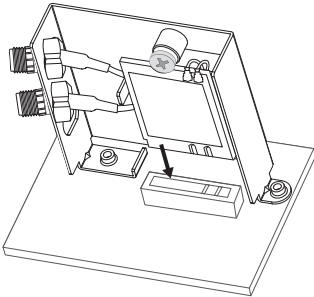

5 Insert WiFi card to M.2 (E Key) socket and cover the outer casing.

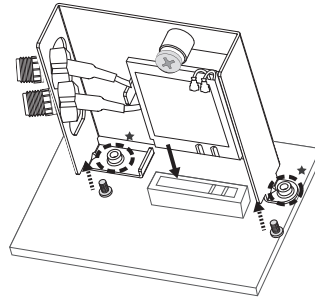

6 Fixing screw.
★ Screws type The bottom of the Mainboard locks the iron piece.



50-WIFICABLE-QB2

